

REVISIONS				
REV	ECN	DESCRIPTION	DATE	APP'D
A	DR8713	RELEASE	01/11/08	RAL

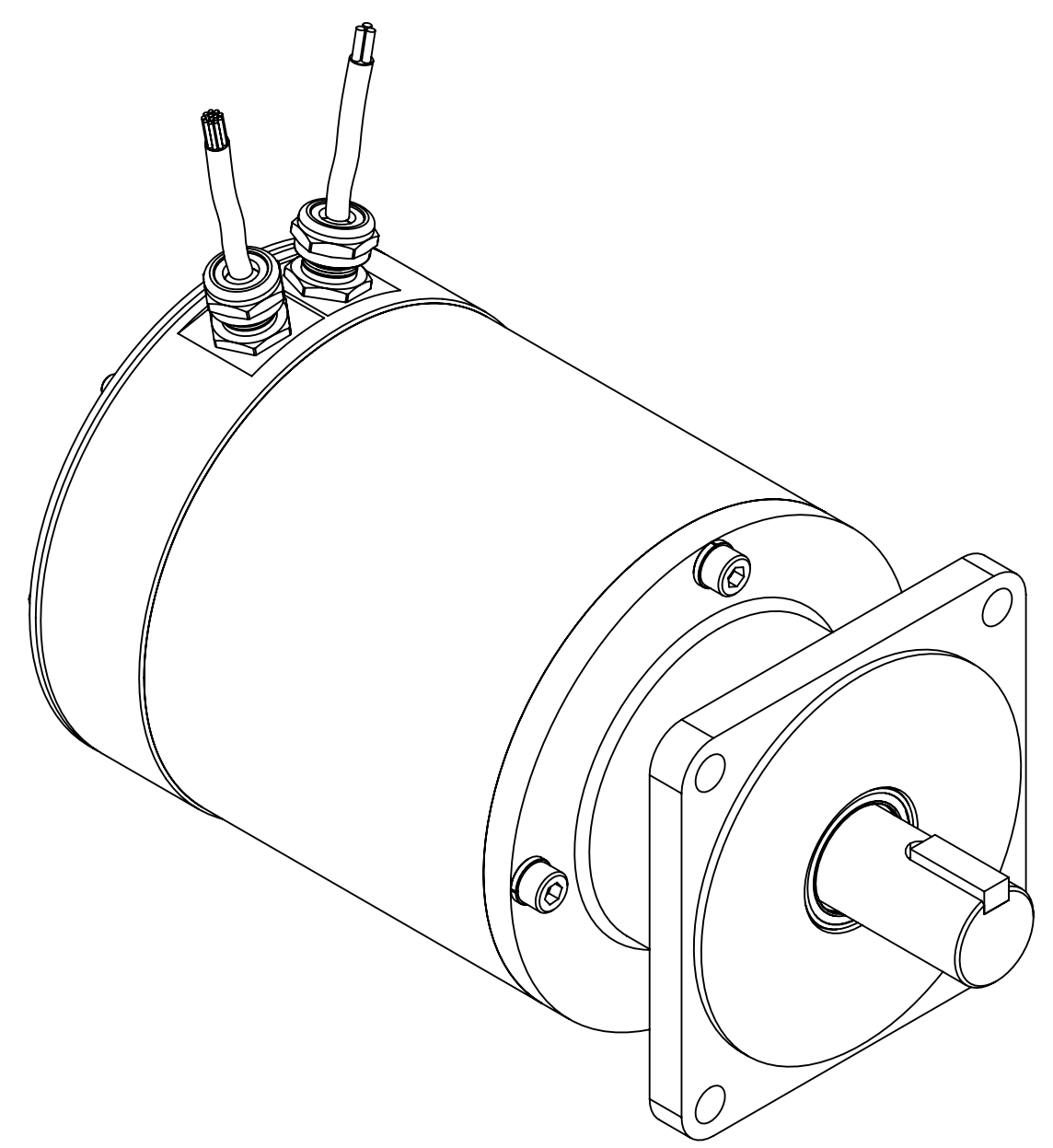

Clockwise rotation, viewed from the motor shaft, results in these waveforms.

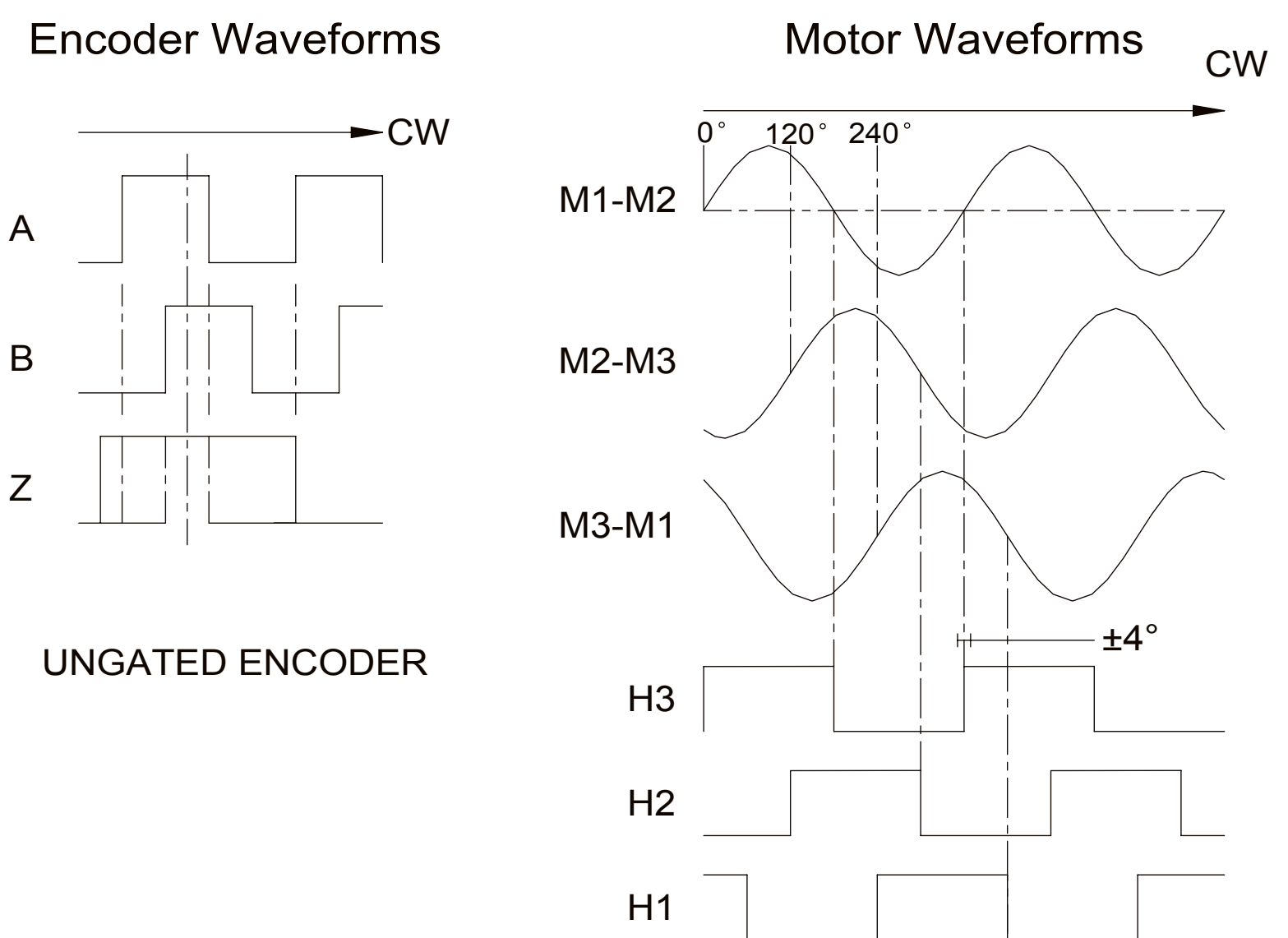

FROM	WIRE COLOR	WIRE SIZE
OUTPUT A	BROWN	# 28 AWG.
OUTPUT A'	WHITE	# 28 AWG.
OUTPUT B	BLUE	# 28 AWG.
OUTPUT B'	GREEN	# 28 AWG.
OUTPUT Z	ORANGE	# 28 AWG.
OUTPUT Z'	YELLOW	# 28 AWG.
OUTPUT U (H3)	VIOLET	# 28 AWG.
OUTPUT V (H2)	BROWN/WHITE	# 28 AWG.
OUTPUT W (H1)	ORANGE/WHITE	# 28 AWG.
CASE GROUND	BLACK/WHITE	# 28 AWG.
CABLE SHIELD	DRAIN	# 28 AWG.
+ 5 VDC	RED	# 28 AWG.
COMMON	BLACK/WHITE	# 28 AWG.
THERMOSTAT	RED/WHITE	#22 AWG.
THERMOSTAT	YELLOW/WHITE	#22 AWG.

FROM	WIRE COLOR	WIRE SIZE
MOTOR M1	WHITE	# 12 AWG
MOTOR M2	WHITE/BLUE	# 12 AWG
MOTOR M3	WHITE/ORANGE	# 12 AWG
CASE	WHITE/GREEN	# 12 AWG

**NOTE:**  
 TEMPERATURE SENSOR:  
 CONTACTS: NORMALLY CLOSED  
 MAX AMPS: 6 AMP  
 RATED VOLTAGE: 24VDC

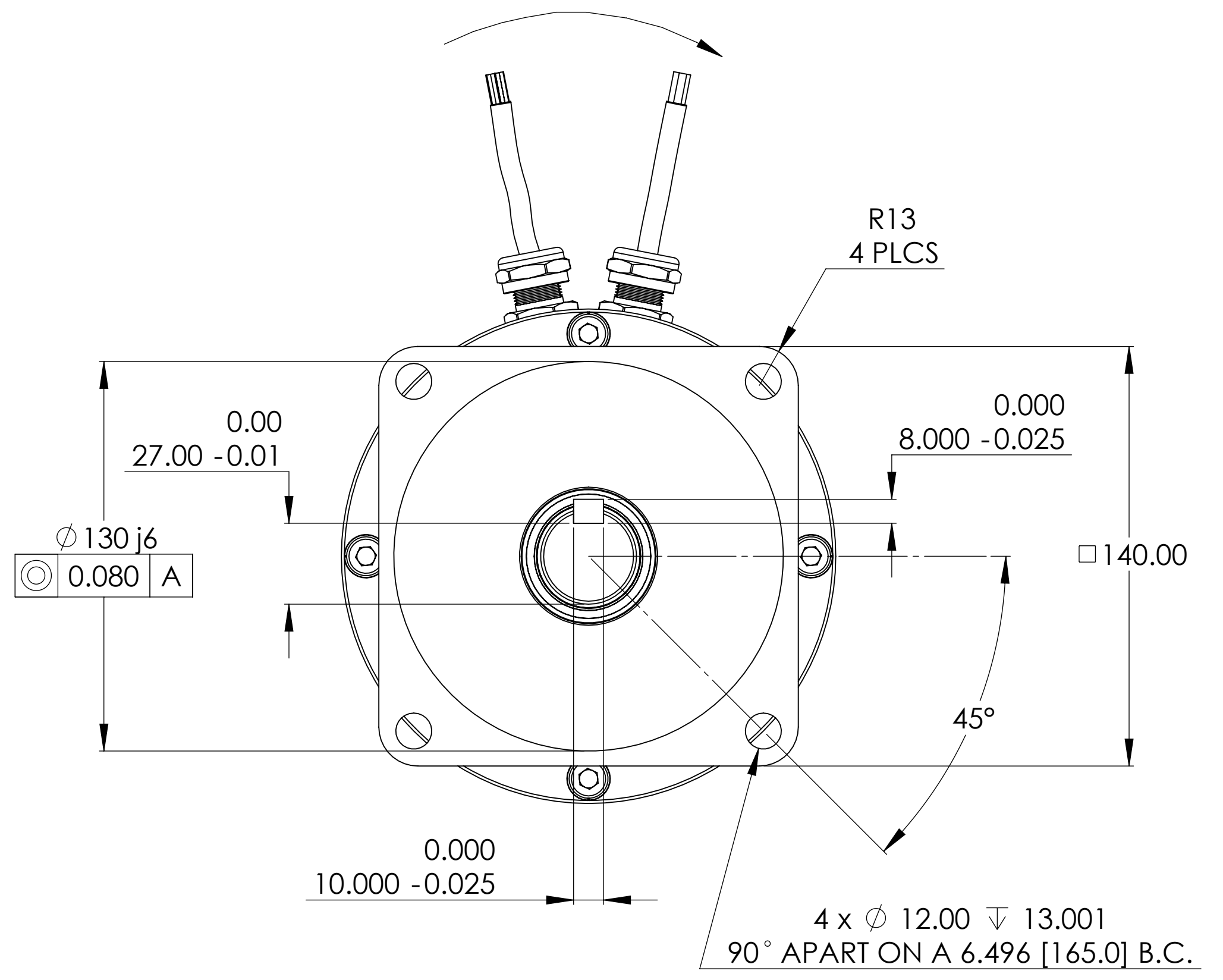
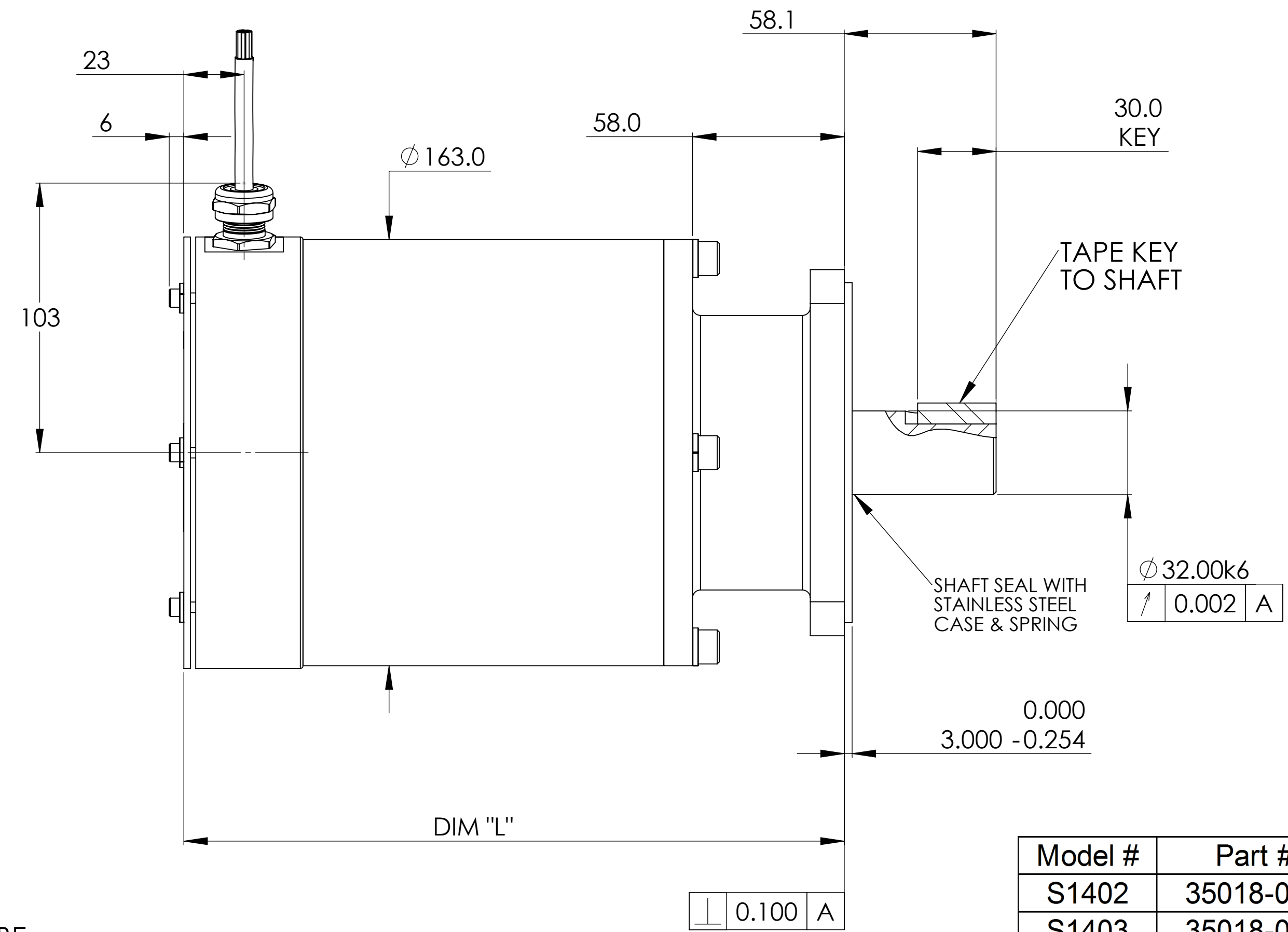
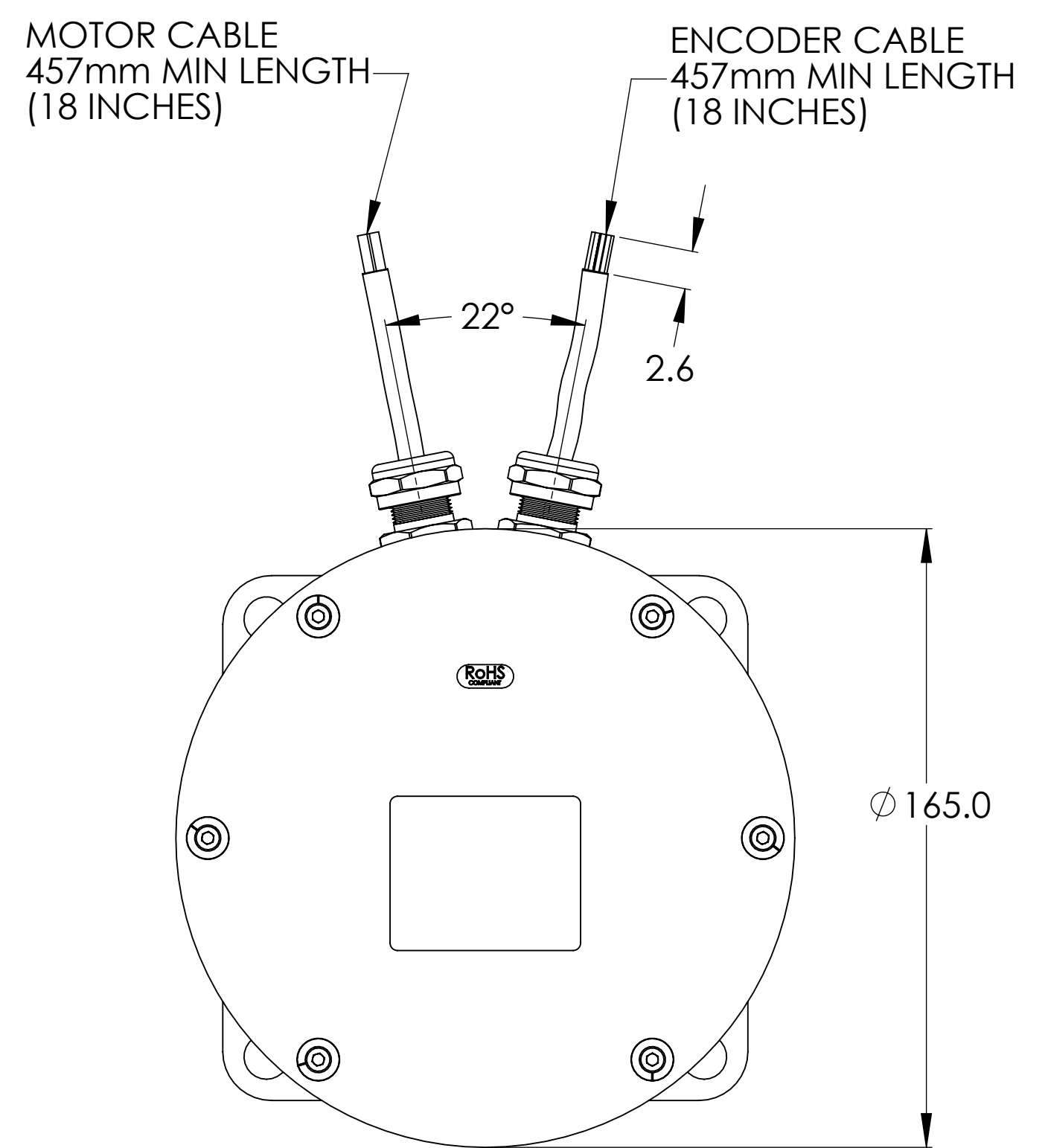

- NOTES:
1. ROTATION: CLOCKWISE MOTOR ROTATION VIEWING DRIVE END OCCURS WHEN PHASE A LEADS PHASE B, PHASE B LEADS PHASE C.
  2. MOTOR IS SEALED TO IP67 STANDARDS:  
 -NO INGRESS OF DUST  
 -INGRESS OF WATER CAUSING HARMFUL EFFECTS SHALL NOT BE POSSIBLE WHEN THE ENCLOSURE IS IMMERSED IN WATER UNDER STANDARDIZED CONDITIONS OF PRESSURE AND TIME (UP TO 1m OF SUBMERSION)

ALL DIMENSIONS ARE IN MILLIMETERS

Model #	Part #	DIM "L"
S1402	35018-035	226.3
S1403	35018-036	251.3
S1404	35018-037	276.3
S1405	35018-038	301.3

<b>NOTICE</b> Information contained herein is the sole property of MTI Torque Systems, Inc. This may not be reproduced, copied, or traced in any manner in part or whole without the written permission by MTI Torque Systems, Inc.	<b>MILLIMETERS (mm)</b> TOLERANCES UNLESS OTHERWISE SPECIFIED X ±0.25 XX ±0.25 XXX ±0.100	APPLICATION NEXT ASSY USED ON 140 mm	 <b>MonteVideo Technology, Inc. (MTI)</b> A Motor And Control Company <b>TORQUE SYSTEMS</b> METRIC STAINLESS STEEL W/ENC., SHAFT SEAL, TEFL CABLE
	ANGLES ±0°-30° MATERIAL FINISH	DRAWN JSQUIRES 03/12/08 CHECKED APPROVED	

CAD FILE: 35018-035-038.SLDDRW